



**OBSTACLES**

- Obstacle 1 – Infiltration
- Obstacle 2 – Under and Overs
- Obstacle 3 – The Vaults
- Obstacle 4 – Incline Walls
- Obstacle 5 – Balance Beams
- Obstacle 6 – Individual Carry - Water
- Obstacle 7 – Pontoon Bridges
- Obstacle 8 – Timber Ladder
- Obstacle 9 – Cliff Assault
- Obstacle 10 – Pipe Dream
- Obstacle 11 – Ring The Bell
- Obstacle 12 – The Tower
- Obstacle 13 – Fire Channels
- Obstacle 14 – Jungle Vine
- Obstacle 15 – The Rig
- Obstacle 16 – A Frame
- Obstacle 17 – Swinging Monkey
- Obstacle 18 – Great Walls
- Obstacle 19 – Torsion Crawl
- Obstacle 20 – Individual Carry - Ammo
- Obstacle 21 – Inversion
- Obstacle 22 – Cargo Crawl
- Obstacle 23 – Cargo Wall
- Obstacle 24 – Tyre Wall
- Obstacle 25 – Traverse Ropes
- Obstacle 26 – Individual Carry - Sand
- Obstacle 27 – Commando Crawl
- Obstacle 28 – Fast Rope
- Obstacle 29 – Vertical Maze
- Obstacle 30 – Swimmer Scout
- Obstacle 31 – Muddy Mounds
- Obstacle 32 – Spinners
- Obstacle 33 – Double Decker
- Obstacle 34 – The Ramp

# FESTIVAL



## OBSTACLES

- Obstacle 15 – The Rig
- Obstacle 16 – A Frame
- Obstacle 17 – Great Walls
- Obstacle 18 – Swinging Monkey
- Obstacle 19 – Torsion Crawl

- Obstacle 31 – Spinners
- Obstacle 32 – Cargo Bridge
- Obstacle 33 – Muddy Mounds
- Obstacle 34 – The Ramp

## Obstacle Requirements

### Obstacle 1 – Infiltration

- Clean out and mark Creek line

### Obstacle 2 – Unders and Overs

- On site horse obstacles (new)

### Obstacle 3 – The Vaults

- On site.

### Obstacle 4 – Incline Walls

- On site.

### Obstacle 5 – Balance Beams (Water jump is now larger)

- Timber on site. Horse jumps to be used as well.

### Obstacle 5 – Individual Carry - Water

- On site.

### Obstacle 6 – Pontoon Bridges

- 26 pontoons on site. Bring 4 x foam pontoons in Caudo shed.
- I will confirm pontoon suitability on site recce.

### Obstacle 7 – Timber Ladder

- On site. Crane into position next to water.

### Obstacle 8 – Cliff Assault

- 2 x unknotted ropes in Pete's trailer / See if ramp needs re-paint.

### Obstacle 9 – Pipe Dream

- On site. Cam nets to dress.

### Obstacle 10 – Ring The Bell

- 4 x knotted and 2 x unknotted ropes on site.

### Obstacle 11 – The Tower

- 2 x 4x4m cargo nets – in Blue Nippys.

### Obstacle 12 – Fire Channels

- Dig in channels. Timber required to be collected.

### Obstacle 13 – Jungle Vine

- Adam buy new ropes. Jungle vine constructed in creek line.
- Star droppers used as well as trees

### Obstacle 14 – Individual Carry – Ammo

- Ammo tins on site.

### Obstacle 15 – The Rig

- On site. Get delivery of sand again to go underneath.

### Obstacle 16 – A Frame

- 8x8m cargo in container on site. Clips on site in bucket.

### Obstacle 17 – Great Walls

- On site. 3 x walls and 1 x half wall.

### Obstacle 18 – Swinging Monkey

- Gal tube and chain to be bought by Adam.
- Truss in container.

## Schedule

Kelecyn Event Period – Thur 26<sup>th</sup> – 29<sup>th</sup> Jul

Week 1 – 30 Jul – 05 Aug 18

Week 2 – 06 – 10 Aug 18

Kelecyn – from 08 Aug 18

# Obstacle Requirements

## Obstacle 19 – Torsion Crawl

- Torsion bars in Sprinter.
- Purchase barbed wire. Same as Sydney.

## Obstacle 20 – Inversion

- On site. Move into position.

## Obstacle 21 – Cargo Crawl

- 20x5m thin cargo net (cricket net) on Pete's trailer.

## Obstacle 22 – Cargo Wall

- 8x4m cargo net on site.
- Ancillary equipment required by Pete.

## Obstacle 23 – Tyre Wall

- On site, craned into position.

## Obstacle 24 – Traverse Ropes

- 6 x green traverse ropes on site.

## Obstacle 25 – Individual Carry – Sand bag

- Adam buy 50 x sand bags. Filled from sand pit on site.

## Obstacle 26 – Commando Crawl

- Adam buy barbed wire. Bring clips.

## Obstacle 27 – Cliff Assault

- 2 x unknotted ropes on site

## Obstacle 28 – Vertical Maze

- On site in position. Adam can re-spray/camo if required.

## Obstacle 29 – Swimmer Scout

- On site (noodles in container).

## Obstacle 30 – Muddy Mounds

- To be dug by Dale.

## Obstacle 31 – Spinners

- Monkey Bars craned to festival area. Spinners already on.
- Needs row of hay bails from Trevor.

## Obstacle 32 – Sway Bridge

- Black 20x5m cargo on site and 2 x 20ft containers.

## Obstacle 33 – The Ramp

- On site. Dale to dig out dam.
- Water levels are good.

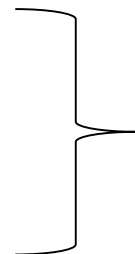

Marks  
Property

# New Obstacle Swinging Monkey

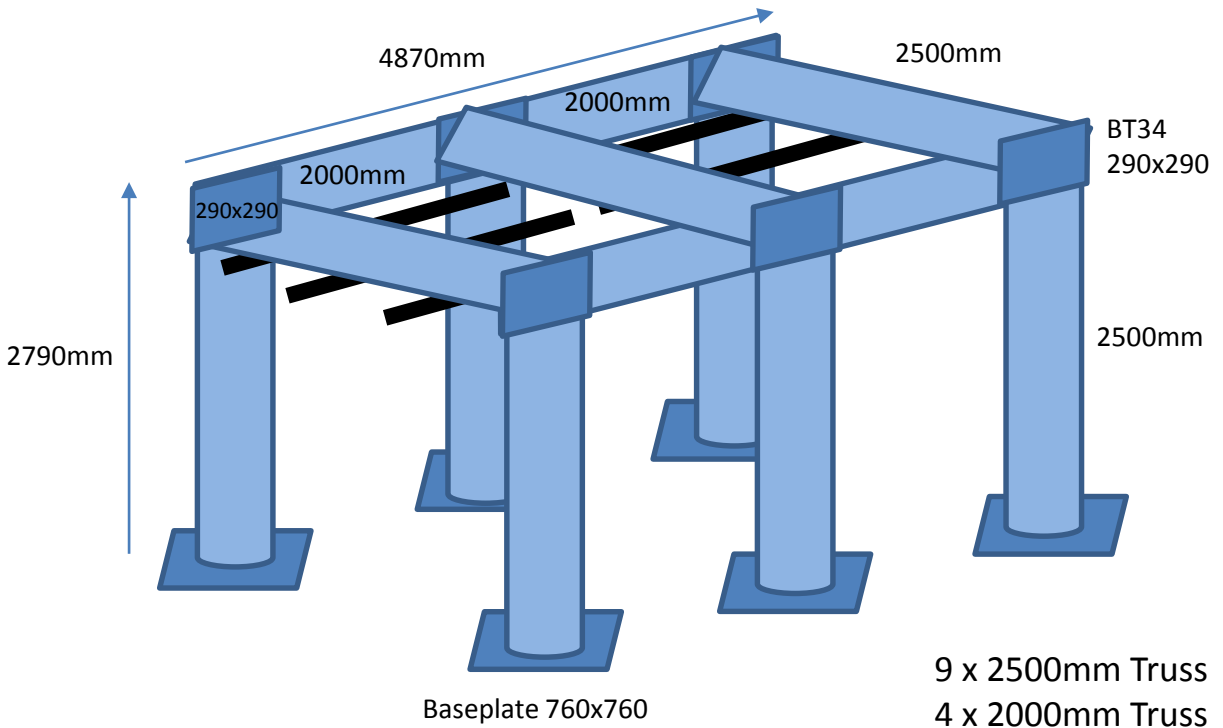

- 9 x 2500mm Truss
- 4 x 2000mm Truss
- 6 x BT34 corners
- 6 x 760mm Baseplates

Extra  
Gal Tube – 6 x 2000mm black pipe

# Site Visit Photos

